



PNEUMATIC COUPLINGS  
PNEUMATISCHE KUPPLUNGEN



SERIE 028S

DN 10.5

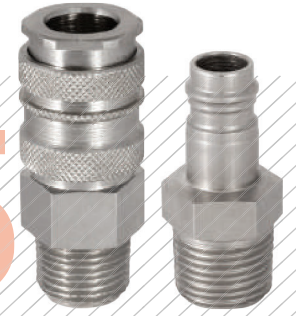

Materials

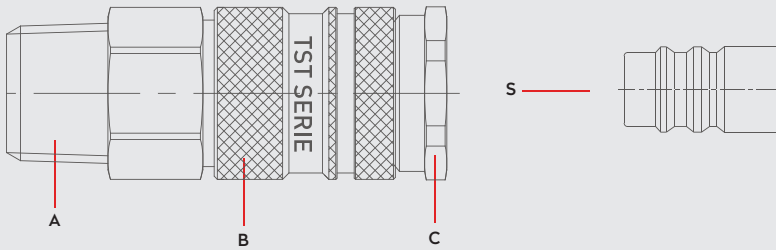

Material Code

- A = Brass Nickel Plated
- B = Steel Nickel Plated
- C = Brass Nickel Plated
- S = Steel Nickel Plated



0 - 35 bar  
(0-508 PSI)



-20° to + 100°C (NBR)  
-4° to + 212°F

Shut Off  
Type

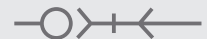

OM 300 - 00700  
OM 300 - 01000  
OM 100 - 01600

SAFETY LOCK

DN 10.5 mm

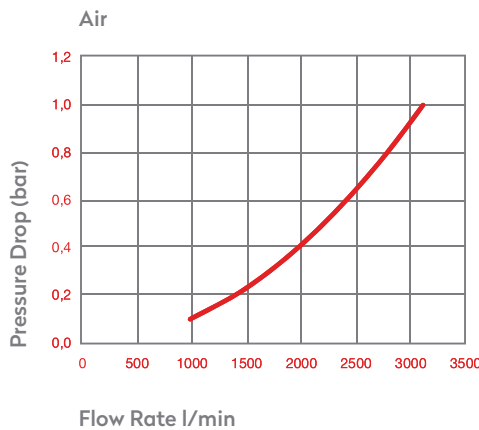

Options

Plug Profile Serie 028S

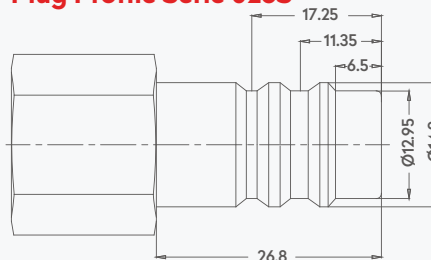

Compatible with

PARKER - RECTUS 28KS



## QUICK COUPLINGS SCHNELLKUPPLUNGEN

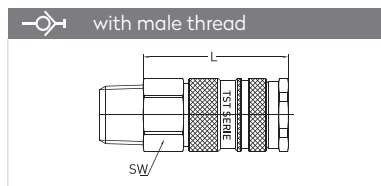

Connection	Part No.	SW	L	ØD
BSPT 3/8"	028 RGS 17	24	69,7	28
BSPT 1/2"	028 RGS 21	24	69,7	28
BSPT 3/4"	028 RGS 26	27	69,7	28

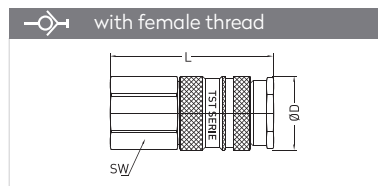

Connection	Part No.	SW	L	ØD
BSP 3/8"	028 DGS 17	24	63,7	28
BSP 1/2"	028 DGS 21	24	66,7	28
BSP 3/4"	028 DGS 26	30	70,7	28

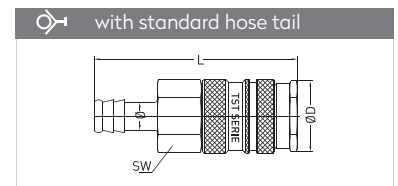

Connection	Part No.	SW	L	ØD
13 mm - 1/2"	028 HGS 13	24	79,7	28
16 mm - 5/8"	028 HGS16	24	79,7	28
19 mm - 3/4"	028 HGS 19	24	79,7	28

## PLUGS STECKNIPPEL

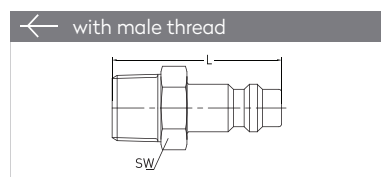

Connection	Part No.	SW	L
BSPT 3/8"	028 RUS 17	17	45
BSPT 1/2"	028 RUS 21	22	49
BSPT 3/4"	028 RUS 26	27	51

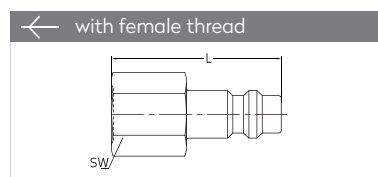

Connection	Part No.	SW	L
BSP 3/8"	028 DUS 17	24	39
BSP 1/2"	028 DUS 21	24	42
BSP 3/4"	028 DUS 26	32	47

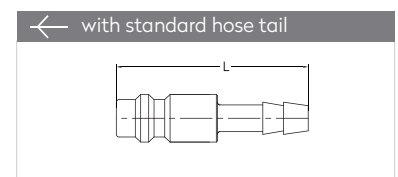

Connection	Part No.	L	ØD
10 mm - 3/8"	028 HUS 10	52	15
13 mm - 1/2"	028 HUS 13	52	15
16 mm - 5/8"	028 HUS 16	54	18
19 mm - 3/4"	028 HUS 19	54	21