

Die klassische und am weitesten verbreitete Verschraubungsserie im Rohrleitungsbau.

Die Teile zeichnen sich durch eine hohe mechanische Beanspruchbarkeit und durch eine Oberflächengüte nach DIN 2444 aus.

Die Teile sind vollkommen mit einer Reinzinkschicht überzogen und somit trinkwassergeeignet, sowie gegen Rost geschützt.

Die Teile finden Verwendung im Rohrleitungsbau, bei der Sanitär- und Gasinstallation, sowie in einer Vielzahl von industriellen Anwendungen.

Maximaler Einsatzbereich bei Minustemperaturen = -20 °C; 25 bar.

Zulässiger Betriebsdruck bei Temperaturen zwischen -20 °C und 120 °C = 25 bar.

Zulässiger Betriebsdruck bei Temperaturen zwischen 120 °C und 300 °C = 20-25 bar.

Bei Produkten mit Flachdichtung ist ein eingeschränkter Temperatur-Bereich von -20 °C bis 200 °C bei max. 25 bar zu berücksichtigen.

Material: schwarzer Temperguss B350-10 Design Symbol A
 Temperaturbereich: -20 °C bis +300 °C (bei 20 bar)
 Oberfläche: feuerverzinkt
 Anschlussgewinde: nach ISO 7-1

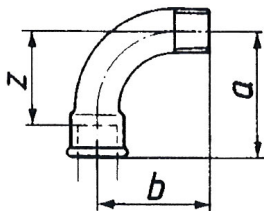

TFB 1-12

Bogen 1, lang, 90°, IG/AG

| Typen Nr. | Artikel Nr. | Gewinde innen | Gewinde außen | a mm | b mm | z mm |
|-----------|-------------|---------------|---------------|-------|-------|-------|
| TFB 1-14 | 112826 | Rp 1/4 | R 1/4 | 40,0 | 36,0 | 30,0 |
| TFB 1-38 | 112827 | Rp 3/8 | R 3/8 | 48,0 | 42,0 | 38,0 |
| TFB 1-12 | 112828 | Rp 1/2 | R 1/2 | 55,0 | 48,0 | 42,0 |
| TFB 1-34 | 112829 | Rp 3/4 | R 3/4 | 69,0 | 60,0 | 54,0 |
| TFB 1-10 | 112830 | Rp 1 | R 1 | 85,0 | 75,0 | 68,0 |
| TFB 1-114 | 112831 | Rp 1 1/4 | R 1 1/4 | 105,0 | 95,0 | 86,0 |
| TFB 1-112 | 112832 | Rp 1 1/2 | R 1 1/2 | 116,0 | 105,0 | 97,0 |
| TFB 1-20 | 112833 | Rp 2 | R 2 | 140,0 | 130,0 | 116,0 |
| TFB 1-212 | 112834 | Rp 2 1/2 | R 2 1/2 | 176,0 | 165,0 | 149,0 |
| TFB 1-30 | 112835 | Rp 3 | R 3 | 205,0 | 190,0 | 175,0 |

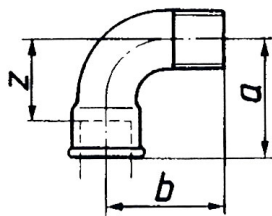

TFB 1A-12

Bogen 1a, kurz, 90°, IG/AG

| Typen Nr. | Artikel Nr. | Gewinde innen | Gewinde außen | a mm | b mm | z mm |
|------------|-------------|---------------|---------------|-------|-------|------|
| TFB 1A-14 | 112836 | Rp 1/4 | R 1/4 | 30,0 | 30,0 | 20,0 |
| TFB 1A-38 | 112837 | Rp 3/8 | R 3/8 | 36,0 | 36,0 | 26,0 |
| TFB 1A-12 | 112838 | Rp 1/2 | R 1/2 | 45,0 | 45,0 | 32,0 |
| TFB 1A-34 | 112839 | Rp 3/4 | R 3/4 | 50,0 | 50,0 | 35,0 |
| TFB 1A-10 | 112840 | Rp 1 | R 1 | 63,0 | 63,0 | 46,0 |
| TFB 1A-114 | 112841 | Rp 1 1/4 | R 1 1/4 | 76,0 | 76,0 | 57,0 |
| TFB 1A-112 | 112842 | Rp 1 1/2 | R 1 1/2 | 85,0 | 85,0 | 66,0 |
| TFB 1A-20 | 112843 | Rp 2 | R 2 | 102,0 | 102,0 | 78,0 |
| TFB 1A-212 | 112844 | Rp 2 1/2 | R 2 1/2 | - | - | - |

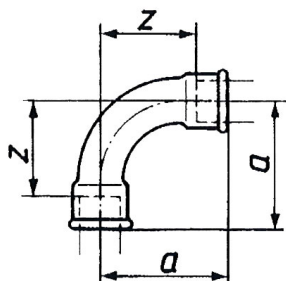

TFB 2-12

Bogen 2, lang, 90°, IG/IG

| Typen Nr. | Artikel Nr. | Gewinde innen | a mm | z mm |
|-----------|-------------|---------------|-------|-------|
| TFB 2-14 | 112845 | Rp/Rp 1/4 | 40,0 | 30,0 |
| TFB 2-38 | 112846 | Rp/Rp 3/8 | 48,0 | 38,0 |
| TFB 2-12 | 112847 | Rp/Rp 1/2 | 55,0 | 42,0 |
| TFB 2-34 | 112848 | Rp/Rp 3/4 | 69,0 | 54,0 |
| TFB 2-10 | 112849 | Rp/Rp 1 | 85,0 | 68,0 |
| TFB 2-114 | 112850 | Rp/Rp 1 1/4 | 105,0 | 86,0 |
| TFB 2-112 | 112851 | Rp/Rp 1 1/2 | 116,0 | 97,0 |
| TFB 2-20 | 112852 | Rp/Rp 2 | 140,0 | 116,0 |
| TFB 2-212 | 112853 | Rp 2 1/2 | 176,0 | 149,0 |
| TFB 2-30 | 112854 | Rp 3 | 205,0 | 175,0 |

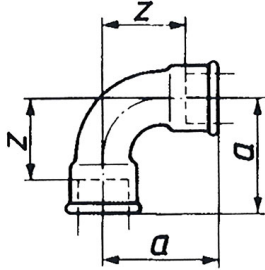

TFB 2A-10

Bogen 2a, kurz, 90°, IG/IG

| Typen Nr. | Artikel Nr. | Gewinde innen | a mm | z mm |
|------------|-------------|---------------|-------|------|
| TFB 2A-14 | 112855 | Rp/Rp 1/4 | 30,0 | 20,0 |
| TFB 2A-38 | 112856 | Rp/Rp 3/8 | 36,0 | 26,0 |
| TFB 2A-12 | 112857 | Rp/Rp 1/2 | 45,0 | 32,0 |
| TFB 2A-34 | 112858 | Rp/Rp 3/4 | 50,0 | 35,0 |
| TFB 2A-10 | 112859 | Rp/Rp 1 | 63,0 | 46,0 |
| TFB 2A-114 | 112860 | Rp/Rp 1 1/4 | 76,0 | 57,0 |
| TFB 2A-112 | 112861 | Rp/Rp 1 1/2 | 85,0 | 66,0 |
| TFB 2A-20 | 112862 | Rp/Rp 2 | 102,0 | 78,0 |

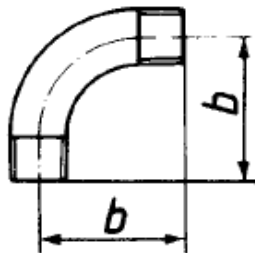

TFB 3-34

Bogen 3, lang, 90°, AG/AG

| Typen Nr. | Artikel Nr. | Gewinde innen | b mm |
|-----------|-------------|---------------|-------|
| TFB 3-38 | 112863 | R 3/8 | 42,0 |
| TFB 3-12 | 112864 | R 1/2 | 48,0 |
| TFB 3-34 | 112865 | R 3/4 | 60,0 |
| TFB 3-10 | 112866 | R 1 | 75,0 |
| TFB 3-114 | 112867 | R 1 1/4 | 95,0 |
| TFB 3-112 | 112868 | R 1 1/2 | 105,0 |
| TFB 3-20 | 112869 | R 2 | 130,0 |

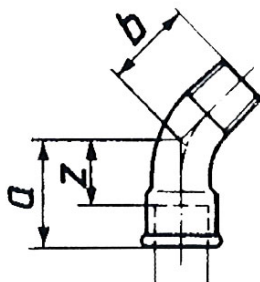

TFB 40-10

Bogen 40, 45°, IG/AG

| Typen Nr. | Artikel Nr. | Gewinde innen | Gewinde außen | a mm | b mm | z mm |
|------------|-------------|---------------|---------------|-------|-------|------|
| TFB 40-14 | 112870 | Rp 1/4 | R 1/4 | 26,0 | 21,0 | 16,0 |
| TFB 40-38 | 112871 | Rp 3/8 | R 3/8 | 30,0 | 24,0 | 20,0 |
| TFB 40-12 | 112872 | Rp 1/2 | R 1/2 | 36,0 | 30,0 | 23,0 |
| TFB 40-34 | 112873 | Rp 3/4 | R 3/4 | 43,0 | 36,0 | 28,0 |
| TFB 40-10 | 112874 | Rp 1 | R 1 | 51,0 | 42,0 | 34,0 |
| TFB 40-114 | 112875 | Rp 1 1/4 | R 1 1/4 | 64,0 | 54,0 | 45,0 |
| TFB 40-112 | 112876 | Rp 1 1/2 | R 1 1/2 | 68,0 | 58,0 | 49,0 |
| TFB 40-20 | 112877 | Rp 2 | R 2 | 81,0 | 70,0 | 57,0 |
| TFB 40-212 | 112878 | Rp 2 1/2 | R 2 1/2 | 99,0 | 86,0 | 72,0 |
| TFB 40-30 | 112879 | Rp 3 | R 3 | 113,0 | 100,0 | 83,0 |

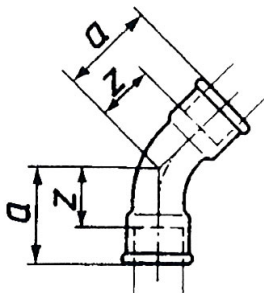

TFB 41-10

Bogen 41, 45°, IG/IG

| Typen Nr. | Artikel Nr. | Gewinde innen | a mm | z mm |
|------------|-------------|---------------|-------|------|
| TFB 41-38 | 112880 | Rp/Rp 3/8 | 30,0 | 20,0 |
| TFB 41-12 | 112881 | Rp/Rp 1/2 | 36,0 | 23,0 |
| TFB 41-34 | 112882 | Rp/Rp 3/4 | 43,0 | 28,0 |
| TFB 41-10 | 112883 | Rp/Rp 1 | 51,0 | 34,0 |
| TFB 41-114 | 112884 | Rp/Rp 1 1/4 | 64,0 | 45,0 |
| TFB 41-112 | 112885 | Rp/Rp 1 1/2 | 68,0 | 49,0 |
| TFB 41-20 | 112886 | Rp/Rp 2 | 81,0 | 57,0 |
| TFB 41-212 | 112887 | Rp/Rp 2 1/2 | 99,0 | 72,0 |
| TFB 41-30 | 112888 | Rp/Rp 3 | 113,0 | 83,0 |

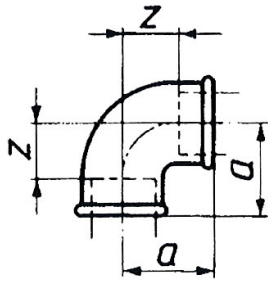

TFW 90-12

Winkel 90, 90°, IG/IG

| Typen Nr. | Artikel Nr. | Gewinde innen | a mm | z mm |
|------------|-------------|---------------|------|------|
| TFW 90-14 | 112889 | Rp/Rp 1/4 | 21,0 | 11,0 |
| TFW 90-38 | 112890 | Rp/Rp 3/8 | 25,0 | 15,0 |
| TFW 90-12 | 112891 | Rp/Rp 1/2 | 28,0 | 15,0 |
| TFW 90-34 | 112892 | Rp/Rp 3/4 | 33,0 | 18,0 |
| TFW 90-10 | 112893 | Rp/Rp 1 | 38,0 | 21,0 |
| TFW 90-114 | 112894 | Rp/Rp 1 1/4 | 45,0 | 26,0 |
| TFW 90-112 | 112895 | Rp/Rp 1 1/2 | 50,0 | 31,0 |
| TFW 90-20 | 112896 | Rp/Rp 2 | 58,0 | 34,0 |
| TFW 90-212 | 112897 | Rp/Rp 2 1/2 | 69,0 | 42,0 |
| TFW 90-30 | 112898 | Rp/Rp 3 | 78,0 | 48,0 |

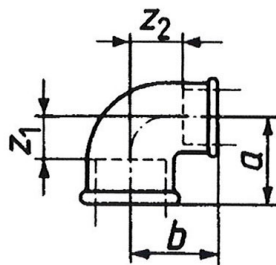

TFW 90-1012

Winkel 90, 90°, reduzierend, IG/IG

| Typen Nr. | Artikel Nr. | Gewinde innen | Gewinde innen | a mm | b mm | c mm | z1 mm | z2 mm |
|---------------|-------------|---------------|---------------|------|------|------|-------|-------|
| TFW 90-1238 | 133560 | Rp 1/2 | Rp 3/8 | 26,0 | 26,0 | 33,0 | 13,0 | 16,0 |
| TFW 90-3412 | 133561 | Rp 3/4 | Rp 1/2 | 30,0 | 31,0 | 40,0 | 15,0 | 18,0 |
| TFW 90-1012 | 133562 | Rp 1 | Rp 1/2 | 32,0 | 34,0 | - | 15,0 | 21,0 |
| TFW 90-1034 | 133563 | Rp 1 | Rp 3/4 | 35,0 | 36,0 | 46,0 | 18,0 | 21,0 |
| TFW 90-11410 | 133564 | Rp 1 1/4 | Rp 1 | 40,0 | 42,0 | 56,0 | 21,0 | 25,0 |
| TFW 90-11212 | 133565 | Rp 1 1/2 | Rp 1/2 | - | - | - | - | - |
| TFW 90-112114 | 133566 | Rp 1 1/2 | Rp 1 1/4 | 46,0 | 48,0 | - | 27,0 | 29,0 |
| TFW 90-21 | 133567 | Rp 2 | Rp 1 | - | - | - | - | - |
| TFW 90-212112 | 133568 | Rp 2 1/2 | Rp 1 1/2 | - | - | - | - | - |

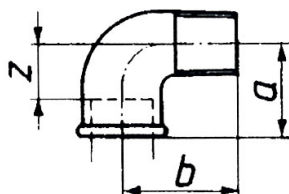

TFW 92-12

Winkel 92, 90°, IG/AG

| Typen Nr. | Artikel Nr. | Gewinde innen | Gewinde außen | a mm | b mm | z mm |
|------------|-------------|---------------|---------------|------|------|------|
| TFW 92-14 | 112899 | Rp 1/4 | R 1/4 | 21,0 | 28,0 | 11,0 |
| TFW 92-38 | 112900 | Rp 3/8 | R 3/8 | 25,0 | 32,0 | 15,0 |
| TFW 92-12 | 112901 | Rp 1/2 | R 1/2 | 28,0 | 37,0 | 15,0 |
| TFW 92-34 | 112902 | Rp 3/4 | R 3/4 | 33,0 | 43,0 | 18,0 |
| TFW 92-10 | 112903 | Rp 1 | R 1 | 38,0 | 52,0 | 21,0 |
| TFW 92-114 | 112904 | Rp 1 1/4 | R 1 1/4 | 45,0 | 60,0 | 26,0 |
| TFW 92-112 | 112905 | Rp 1 1/2 | R 1 1/2 | 50,0 | 65,0 | 31,0 |
| TFW 92-20 | 112906 | Rp 2 | R 2 | 58,0 | 74,0 | 34,0 |
| TFW 92-212 | 112907 | Rp 2 1/2 | R 2 1/2 | 69,0 | 88,0 | 42,0 |
| TFW 92-30 | 112908 | Rp 3 | R 3 | 78,0 | 98,0 | 48,0 |

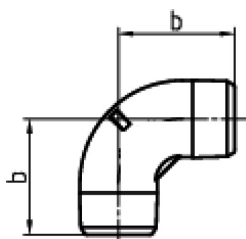

TFW 94-38

Winkel 94, 90°, AG/AG

| Typen Nr. | Artikel Nr. | Gewinde außen | b mm |
|------------|-------------|---------------|------|
| TFW 94-38 | 112909 | R/R 3/8 | 30,0 |
| TFW 94-12 | 112910 | R/R 1/2 | 37,0 |
| TFW 94-34 | 112911 | R/R 3/4 | 40,0 |
| TFW 94-10 | 112912 | R/R 1 | 47,0 |
| TFW 94-114 | 112913 | R/R 1 1/4 | 57,0 |
| TFW 94-112 | 112914 | R/R 1 1/2 | 60,0 |
| TFW 94-20 | 112915 | R/R 2 | 70,0 |

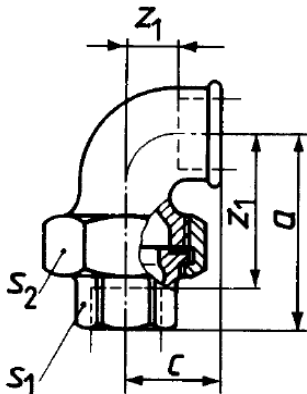

TFV 95-10

Verschraubung Bogen 95, flach dichtend, IG/IG, ohne Dichtung
Temperaturbereich -20 °C bis 200 °C

| Typen Nr. | Artikel Nr. | Gewinde innen | a mm | b mm | c mm | z1 mm |
|------------|-------------|---------------|-------|-------|------|-------|
| TFV 95-12 | 112916 | Rp 1/2 | 58,0 | 76,0 | 28,0 | 15,0 |
| TFV 95-34 | 112917 | Rp 3/4 | 62,0 | 82,0 | 33,0 | 18,0 |
| TFV 95-10 | 112918 | Rp 1 | 72,0 | 94,0 | 38,0 | 21,0 |
| TFV 95-114 | 112919 | Rp 1 1/4 | 82,0 | 107,0 | 45,0 | 26,0 |
| TFV 95-112 | 112920 | Rp 1 1/2 | 90,0 | 115,0 | 50,0 | 31,0 |
| TFV 95-20 | 112921 | Rp 2 | 100,0 | 128,0 | 58,0 | 34,0 |

→ Maximale Temperatur und maximaler Betriebsdruck dürfen nicht gleichzeitig auftreten!

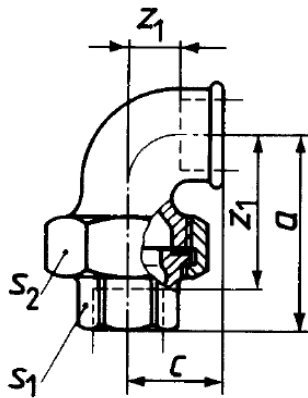

TFV 96-10

Verschraubung Bogen 96, konisch dichtend, IG/IG

| Typen Nr. | Artikel Nr. | Gewinde innen | a mm | b mm | Z ₁ mm |
|------------|-------------|---------------|-------|-------|-------------------|
| TFV 96-12 | 112922 | Rp 1/2 | 58,0 | 76,0 | 15,0 |
| TFV 96-34 | 112923 | Rp 3/4 | 62,0 | 82,0 | 18,0 |
| TFV 96-10 | 112924 | Rp 1 | 72,0 | 94,0 | 21,0 |
| TFV 96-114 | 112925 | Rp 1 1/4 | 82,0 | 107,0 | 26,0 |
| TFV 96-112 | 112926 | Rp 1 1/2 | 90,0 | 115,0 | 31,0 |
| TFV 96-20 | 112927 | Rp 2 | 100,0 | 128,0 | 34,0 |
| TFV 96-212 | 112928 | Rp 2 1/2 | - | - | - |

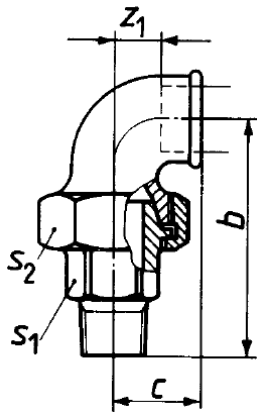

TFV 98-10

Verschraubung Bogen 97, flach dichtend, IG/AG, ohne Dichtung
 Temperaturbereich -20 °C bis 200 °C

| Typen Nr. | Artikel Nr. | Gewinde 1 außen | Gewinde 2 außen | b mm | c mm | Z ₁ mm |
|------------|-------------|-----------------|-----------------|-------|------|-------------------|
| TFV 97-12 | 112929 | Rp 1/2 | R 1/2 | 76,0 | 28,0 | 15,0 |
| TFV 97-34 | 112930 | Rp 3/4 | R 3/4 | 82,0 | 33,0 | 18,0 |
| TFV 97-10 | 112931 | Rp 1 | R 1 | 94,0 | 38,0 | 21,0 |
| TFV 97-114 | 112932 | Rp 1 1/4 | R 1 1/4 | 45,0 | 45,0 | 26,06 |
| TFV 97-112 | 112933 | Rp 1 1/2 | R 1 1/2 | 115,0 | 50,0 | 31,0 |
| TFV 97-20 | 112934 | Rp 2 | R 2 | 128,0 | 58,0 | 34,0 |

→ Maximale Temperatur und maximaler Betriebsdruck dürfen nicht gleichzeitig auftreten!

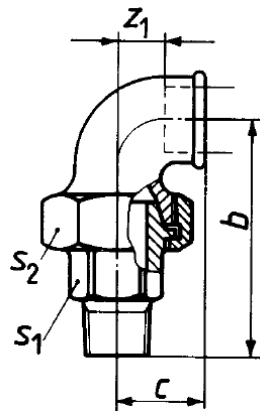

TFV 98-10

Verschraubung Bogen 98, konisch dichtend, IG/AG

| Typen Nr. | Artikel Nr. | Gewinde 1 außen | Gewinde 2 außen | b mm | c mm | Z ₁ mm |
|------------|-------------|-----------------|-----------------|-------|------|-------------------|
| TFV 98-14 | 112935 | Rp 1/4 | R 1/4 | 61,0 | 21,0 | 11,0 |
| TFV 98-12 | 112936 | Rp 1/2 | R 1/2 | 76,0 | 28,0 | 15,0 |
| TFV 98-34 | 112937 | Rp 3/4 | R 3/4 | 82,0 | 33,0 | 18,0 |
| TFV 98-10 | 112938 | Rp 1 | R 1 | 94,0 | 38,0 | 21,0 |
| TFV 98-114 | 112939 | Rp 1 1/4 | R 1 1/4 | 107,0 | 45,0 | 26,0 |
| TFV 98-112 | 112940 | Rp 1 1/2 | R 1 1/2 | 115,0 | 50,0 | 31,0 |
| TFV 98-20 | 112941 | Rp 2 | R 2 | 128,0 | 58,0 | 34,0 |
| TFV 98-212 | 112942 | Rp 2 1/2 | R 2 1/2 | - | - | - |

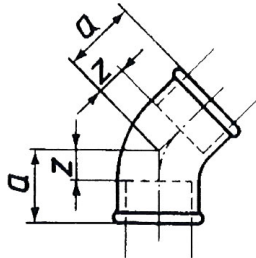

TFW 120-12

Winkel 120, 45°, IG/IG

| Typen Nr. | Artikel Nr. | Gewinde innen | a mm | z mm |
|-------------|-------------|---------------|------|------|
| TFW 120-38 | 112943 | Rp/Rp /3/8 | 20,0 | 10,0 |
| TFW 120-12 | 112944 | Rp/Rp 1/2 | 22,0 | 9,0 |
| TFW 120-34 | 112945 | Rp/Rp 3/4 | 25,0 | 10,0 |
| TFW 120-10 | 112946 | Rp/Rp 1 | 28,0 | 11,0 |
| TFW 120-114 | 112947 | Rp/Rp 1 1/4 | 33,0 | 14,0 |
| TFW 120-112 | 112948 | Rp/Rp 1 1/2 | 36,0 | 17,0 |
| TFW 120-20 | 112949 | Rp/Rp 2 | 43,0 | 19,0 |
| TFW 120-212 | 112950 | Rp 2 1/2 | - | - |
| TFW 120-30 | 112951 | Rp 3 | - | - |

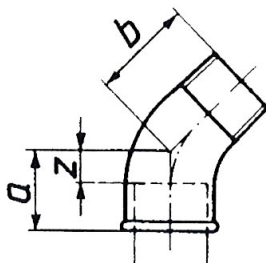

TFW 121-12

Winkel 121, 45°, IG/AG

| Typen Nr. | Artikel Nr. | Gewinde innen | Gewinde außen | a mm | b mm | z mm |
|-------------|-------------|---------------|---------------|------|------|------|
| TFW 121-38 | 112952 | Rp 3/8 | R 3/8 | 20,0 | 25,0 | 10,0 |
| TFW 121-12 | 112953 | Rp 1/2 | R 1/2 | 22,0 | 28,0 | 9,0 |
| TFW 121-34 | 112954 | Rp 3/4 | R 3/4 | 25,0 | 32,0 | 10,0 |
| TFW 121-10 | 112955 | Rp 1 | R 1 | 28,0 | 37,0 | 11,0 |
| TFW 121-114 | 112956 | Rp 1 1/4 | R 1 1/4 | 33,0 | 43,0 | 14,0 |
| TFW 121-112 | 112957 | Rp 1 1/2 | R 1 1/2 | 36,0 | 46,0 | 17,0 |
| TFW 121-20 | 112958 | Rp 2 | R 2 | 43,0 | 55,0 | 19,0 |

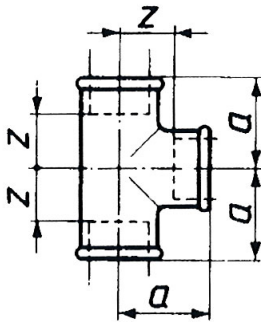

TFT 130-12

T-Stück 130, IG/IG/IG

| Typen Nr. | Artikel Nr. | Gewinde innen | a mm | z mm |
|-------------|-------------|---------------|------|------|
| TFT 130-14 | 112959 | Rp 1/4 | 21,0 | 11,0 |
| TFT 130-38 | 112960 | Rp 3/8 | 25,0 | 15,0 |
| TFT 130-12 | 112961 | Rp 1/2 | 28,0 | 15,0 |
| TFT 130-34 | 112962 | Rp 3/4 | 33,0 | 18,0 |
| TFT 130-10 | 112963 | Rp 1 | 38,0 | 21,0 |
| TFT 130-114 | 112964 | Rp 1 1/4 | 45,0 | 26,0 |
| TFT 130-112 | 112965 | Rp 1 1/2 | 50,0 | 31,0 |
| TFT 130-20 | 112966 | Rp 2 | 58,0 | 34,0 |
| TFT 130-212 | 112967 | Rp 2 1/2 | 69,0 | 42,0 |
| TFT 130-30 | 112968 | Rp 3 | 78,0 | 48,0 |

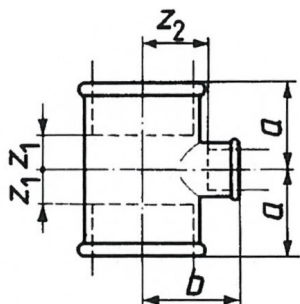

TFT 130-3438

T-Stück 130, reduzierend, IG/IG/IG

| Typen Nr. | Artikel Nr. | Gewinde 1 | Gewinde 2 T-Abzweig reduziert | a mm | b mm | z ₁ mm | z ₂ mm |
|---------------|-------------|-------------|-------------------------------------|---------|---------|----------------------|----------------------|
| TFT 130-3814 | 112969 | Rp/Rp 3/8 | Rp1/4 | 23,0 | 23,0 | 13,0 | 13,0 |
| TFT 130-1214 | 112970 | Rp/Rp 1/2 | Rp 1/4 | 24,0 | 24,0 | 11,0 | 14,0 |
| TFT 130-1238 | 112971 | Rp/Rp 1/2 | Rp 3/8 | 26,0 | 26,0 | 13,0 | 16,0 |
| TFT 130-3414 | 125298 | Rp/Rp 3/4 | Rp 1/4 | 26,0 | 27,0 | 11,0 | 17,0 |
| TFT 130-3438 | 112973 | Rp/Rp 3/4 | Rp 3/8 | 28,0 | 28,0 | 13,0 | 18,0 |
| TFT 130-3412 | 112974 | Rp/Rp 3/4 | Rp 1/2 | 30,0 | 31,0 | 15,0 | 18,0 |
| TFT 130-1038 | 112975 | Rp/Rp 1 | Rp 3/8 | 30,0 | 32,0 | 13,0 | 22,0 |
| TFT 130-1012 | 112976 | Rp/Rp 1 | Rp 1/2 | 32,0 | 34,0 | 15,0 | 21,0 |
| TFT 130-1034 | 112977 | Rp/Rp 1 | Rp 3/4 | 35,0 | 36,0 | 18,0 | 21,0 |
| TFT 130-11438 | 125297 | Rp/Rp 1 1/4 | Rp 3/8 | 32,0 | 36,0 | 13,0 | 26,0 |
| TFT 130-11412 | 112979 | Rp/Rp 1 1/4 | Rp 1/2 | 34,0 | 38,0 | 15,0 | 25,0 |
| TFT 130-11434 | 112980 | Rp/Rp 1 1/4 | Rp 3/4 | 36,0 | 41,0 | 17,0 | 26,0 |
| TFT 130-11410 | 112981 | Rp/Rp 1 1/4 | Rp 1 | 40,0 | 42,0 | 21,0 | 25,0 |
| TFT 130-11238 | 125296 | Rp/Rp 1 1/2 | Rp 3/8 | 33,0 | 38,0 | 14,0 | 28,0 |
| TFT 130-11212 | 112983 | Rp/Rp 1 1/2 | Rp 1/2 | 36,0 | 42,0 | 17,0 | 29,0 |
| TFT 130-11234 | 112984 | Rp/Rp 1 1/2 | Rp 3/4 | 38,0 | 44,0 | 19,0 | 29,0 |
| TFT 130-11210 | 112985 | Rp/Rp 1 1/2 | Rp 1 | 42,0 | 46,0 | 23,0 | 29,0 |
| TFT130-112114 | 112986 | Rp/Rp 1 1/2 | Rp 1 1/4 | 46,0 | 48,0 | 27,0 | 29,0 |
| TFT 130-2012 | 112987 | Rp/Rp 2 | Rp 1/2 | 38,0 | 48,0 | 14,0 | 35,0 |
| TFT 130-2034 | 112988 | Rp/Rp 2 | Rp 3/4 | 40,0 | 50,0 | 16,0 | 35,0 |
| TFT 130-2010 | 112989 | Rp/Rp 2 | Rp 1 | 44,0 | 52,0 | 20,0 | 35,0 |
| TFT 130-20114 | 112990 | Rp/Rp 2 | Rp 1 1/4 | 48,0 | 54,0 | 24,0 | 35,0 |
| TFT 130-20112 | 112991 | Rp/Rp 2 | Rp 1 1/2 | 52,0 | 55,0 | 28,0 | 36,0 |
| TFT 130-21210 | 112992 | Rp/Rp 2 1/2 | Rp 1 | 47,0 | 60,0 | 20,0 | 43,0 |
| TFT130-212114 | 112993 | Rp/Rp 2 1/2 | Rp 1 1/4 | 52,0 | 62,0 | 25,0 | 43,0 |
| TFT130-212112 | 112994 | Rp/Rp 2 1/2 | Rp 1 1/2 | 55,0 | 63,0 | 28,0 | 44,0 |
| TFT 130-21220 | 112995 | Rp/Rp 2 1/2 | Rp 2 | 61,0 | 66,0 | 34,0 | 42,0 |
| TFT 130-3020 | 112996 | Rp/Rp 3 | Rp 2 | 64,0 | 73,0 | 34,0 | 49,0 |
| TFT 130-30212 | 112997 | Rp/Rp 3 | Rp 1 1/2 | 58,0 | 71,0 | 28,0 | 52,0 |

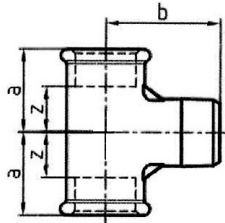

TFT 133-38

T-Stück 133, IG/AG/IG

| Typen Nr. | Artikel Nr. | Gewinde | a mm | b mm | z mm |
|------------|-------------|---------|------|------|------|
| TFT 133-38 | 112998 | Rp 3/8 | 22 | 31 | 12 |
| TFT 133-12 | 112999 | Rp 1/2 | 25 | 38 | 12 |
| TFT 133-10 | 113000 | Rp 1 | 39 | 53 | 22 |



TFT 134-10

T-Stück 134, IG/IG/AG

| Typen Nr. | Artikel Nr. | Gewinde1 | Gewinde2 | Gewinde3 |
|-------------|-------------|----------|----------|----------|
| TFT 134-12 | 113001 | Rp 1/2 | R 1/2 | Rp 1/2 |
| TFT 134-34 | 113002 | Rp 3/4 | R 3/4 | Rp 3/4 |
| TFT 134-10 | 113003 | Rp 1 | R 1 | Rp 1 |
| TFT 134-114 | 113004 | Rp 1 1/4 | R 1 1/4 | Rp 1 1/4 |
| TFT 134-112 | 113005 | Rp 1 1/2 | R 1 1/2 | Rp 1 1/2 |
| TFT 134-20 | 113006 | Rp 2 | R 2 | Rp 2 |

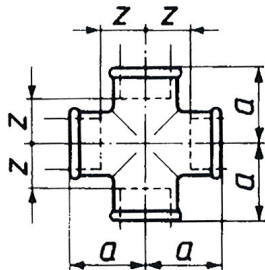

TFK 180-12

Kreuzstück 180, 4 x IG

| Typen Nr. | Artikel Nr. | Gewinde innen | a mm | z mm |
|-------------|-------------|---------------|------|------|
| TFK 180-14 | 113007 | Rp 1/4 | 21,0 | 11,0 |
| TFK 180-38 | 113008 | Rp 3/8 | 25,0 | 15,0 |
| TFK 180-12 | 113009 | Rp 1/2 | 28,0 | 15,0 |
| TFK 180-34 | 113010 | Rp 3/4 | 33,0 | 18,0 |
| TFK 180-10 | 113011 | Rp 1 | 38,0 | 21,0 |
| TFK 180-114 | 113012 | Rp 1 1/4 | 45,0 | 26,0 |
| TFK 180-112 | 113013 | Rp 1 1/2 | 50,0 | 31,0 |
| TFK 180-20 | 113014 | Rp 2 | 58,0 | 34,0 |
| TFK 180-30 | 113015 | Rp 3 | 78,0 | 48,0 |

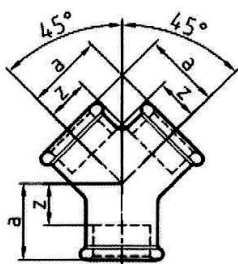

TFY 22-10

Y-Stück 220, IG/IG/IG

| Typen Nr. | Artikel Nr. | Gewinde innen | a mm | z mm |
|------------|-------------|---------------|------|------|
| TFY 220-12 | 113016 | Rp 1/2 | 27,0 | 14,0 |
| TFY 220-34 | 113017 | Rp 3/4 | 33,0 | 18,0 |
| TFY 220-10 | 113018 | Rp 1 | 40,0 | 23,0 |

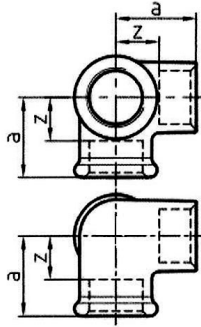

TFE 221-10

Winkelverteiler 221, IG/IG/IG

| Typen Nr. | Artikel Nr. | Gewinde innen | a mm | z mm |
|-------------|-------------|---------------|------|------|
| TFE 221-12 | 113019 | Rp 1/2 | 28,0 | 15,0 |
| TFE 221-34 | 113020 | Rp 3/4 | 33,0 | 18,0 |
| TFE 221-10 | 113021 | Rp 1 | 38,0 | 21,0 |
| TFE 221-112 | 113022 | Rp 1 1/2 | 50,0 | 31,0 |
| TFE 221-20 | 113023 | Rp 2 | 58,0 | 34,0 |

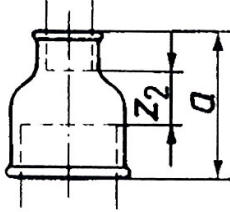

TFM 240-1012

Muffe 240, reduzierend, IG/IG

| Typen Nr. | Artikel Nr. | Gewinde 1 innen | Gewinde 2 innen | a mm | z ₂ mm |
|---------------|-------------|-----------------|-----------------|------|-------------------|
| TFM 240-3814 | 113024 | Rp 3/8 | Rp 1/4 | 30,0 | 10,0 |
| TFM 240-1214 | 113025 | Rp 1/2 | Rp 1/4 | 36,0 | 13,0 |
| TFM 240-1238 | 113026 | Rp 1/2 | Rp 3/8 | 36,0 | 13,0 |
| TFM 240-3414 | 113027 | Rp 3/4 | Rp 1/4 | 39,0 | 14,0 |
| TFM 240-3438 | 113028 | Rp 3/4 | Rp 3/8 | 39,0 | 14,0 |
| TFM 240-3412 | 113029 | Rp 3/4 | Rp 1/2 | 38,0 | 11,0 |
| TFM 240-1038 | 113030 | Rp 1 | Rp 3/8 | 45,0 | 18,0 |
| TFM 240-1012 | 113031 | Rp 1 | Rp 1/2 | 45,0 | 15,0 |
| TFM 240-1034 | 113032 | Rp 1 | Rp 3/4 | 45,0 | 13,0 |
| TFM 240-11438 | 125295 | Rp 1 1/4 | Rp 3/8 | 50,0 | 21,0 |
| TFM 240-11412 | 113034 | Rp 1 1/4 | Rp 1/2 | 50,0 | 18,0 |
| TFM 240-11434 | 113035 | Rp 1 1/4 | Rp 3/4 | 50,0 | 16,0 |
| TFM 240-11410 | 113036 | Rp 1 1/4 | Rp 1 | 50,0 | 14,0 |
| TFM 240-11212 | 113037 | Rp 1 1/2 | Rp 1/2 | 55,0 | 23,0 |
| TFM 240-11234 | 113038 | Rp 1 1/2 | Rp 3/4 | 55,0 | 21,0 |
| TFM 240-11210 | 113039 | Rp 1 1/2 | Rp 1 | 55,0 | 19,0 |
| TFM240-112114 | 113040 | Rp 1 1/2 | Rp 1 1/4 | 55,0 | 17,0 |
| TFM 240-2012 | 113041 | Rp 2 | Rp 1/2 | 65,0 | 28,0 |
| TFM 240-2034 | 113042 | Rp 2 | Rp 3/4 | 65,0 | 26,0 |
| TFM 240-2010 | 113043 | Rp 2 | Rp 1 | 65,0 | 24,0 |
| TFM 240-20114 | 113044 | Rp 2 | Rp 1 1/4 | 65,0 | 22,0 |
| TFM 240-20112 | 113045 | Rp 2 | Rp 1 1/2 | 65,0 | 22,0 |
| TFM 240-21220 | 113046 | Rp 2 1/2 | Rp 2 | 74,0 | 23,0 |
| TFM 240-30112 | 113047 | Rp 3 | Rp 1 1/2 | 80,0 | 31,0 |
| TFM 240-3020 | 113048 | Rp 3 | Rp 2 | 80,0 | 26,0 |
| TFM 240-30212 | 113049 | Rp 3 | Rp 2 1/2 | 80,0 | 23,0 |

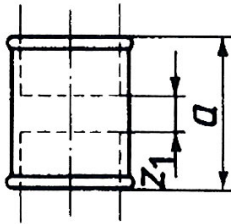

TFM 270-12

Muffe 270, IG/IG

| Typen Nr. | Artikel Nr. | Gewinde innen | a mm | z ₁ mm |
|-------------|-------------|---------------|------|-------------------|
| TFM 270-14 | 113050 | Rp/Rp 1/4 | 27,0 | 7,0 |
| TFM 270-38 | 113051 | Rp/Rp 3/8 | 30,0 | 10,0 |
| TFM 270-12 | 113052 | Rp/Rp 1/2 | 36,0 | 10,0 |
| TFM 270-34 | 113053 | Rp/Rp 3/4 | 39,0 | 9,0 |
| TFM 270-10 | 113054 | Rp/Rp 1 | 45,0 | 11,0 |
| TFM 270-114 | 113055 | Rp/Rp 1 1/4 | 50,0 | 12,0 |
| TFM 270-112 | 113056 | Rp/Rp 1 1/2 | 50,0 | 17,0 |
| TFM 270-20 | 113057 | Rp/Rp 2 | 65,0 | 17,0 |
| TFM 270-212 | 113058 | Rp 2 1/2 | 74,0 | 20,0 |
| TFM 270-30 | 113059 | Rp 3 | 80,0 | 20,0 |

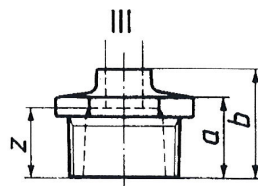
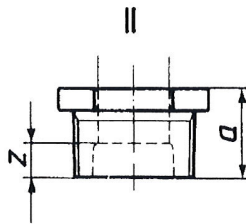
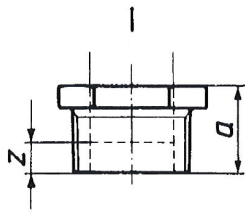

TFR 241-1214

Reduzierstück 241, AG/IG

| Typen Nr. | Artikel Nr. | Gewinde 1 außen | Gewinde 2 innen | a mm | b mm | z mm | Form |
|---------------|-------------|-----------------|-----------------|------|------|------|------|
| TFR 241-3814 | 113060 | R 3/8 | Rp 1/4 | 20,0 | - | 10,0 | I |
| TFR 241-1214 | 113061 | R 1/2 | Rp 1/4 | 24,0 | - | 14,0 | II |
| TFR 241-1238 | 113062 | R 1/2 | Rp 3/8 | 24,0 | - | 14,0 | I |
| TFR 241-3414 | 113063 | R 3/4 | Rp 1/4 | 26,0 | - | 16,0 | II |
| TFR 241-3438 | 113064 | R 3/4 | Rp 3/8 | 26,0 | - | 16,0 | II |
| TFR 241-3412 | 113065 | R 3/4 | Rp 1/2 | 26,0 | - | 13,0 | I |
| TFR 241-1038 | 113066 | R 1 | Rp 3/8 | 29,0 | - | 19,0 | II |
| TFR 241-1012 | 113067 | R 1 | Rp 1/2 | 29,0 | - | 16,0 | II |
| TFR 241-1034 | 113068 | R 1 | Rp 3/4 | 29,0 | - | 14,0 | I |
| TFR 241-11438 | 113069 | R 1 1/4 | Rp 3/8 | 31,0 | - | 21,0 | II |
| TFR 241-11412 | 113070 | R 1 1/4 | Rp 1/2 | 31,0 | - | 18,0 | II |
| TFR 241-11434 | 113071 | R 1 1/4 | Rp 3/4 | 31,0 | - | 16,0 | II |
| TFR 241-11410 | 113072 | R 1 1/4 | Rp 1 | 31,0 | - | 14,0 | I |
| TFR 241-11238 | 113073 | R 1 1/2 | Rp 3/8 | 31,0 | - | 21,0 | II |
| TFR 241-11212 | 113074 | R 1 1/2 | Rp 1/2 | 31,0 | - | 18,0 | II |
| TFR 241-11234 | 113075 | R 1 1/2 | Rp 3/4 | 31,0 | - | 16,0 | II |
| TFR 241-11210 | 113076 | R 1 1/2 | Rp 1 | 31,0 | - | 14,0 | II |
| TFR241-112114 | 113077 | R 1 1/2 | Rp 1 1/4 | 31,0 | - | 12,0 | I |
| TFR 241-2012 | 113078 | R 2 | Rp 1/2 | 35,0 | 48,0 | 35,0 | III |
| TFR 241-2034 | 113079 | R 2 | Rp 3/4 | 35,0 | 48,0 | 33,0 | III |
| TFR 241-2010 | 113080 | R 2 | Rp 1 | 35,0 | - | 18,0 | II |
| TFR 241-20114 | 113081 | R 2 | Rp 1 1/4 | 35,0 | - | 16,0 | II |
| TFR 241-20112 | 113082 | R 2 | Rp 1 1/2 | 35,0 | - | 16,0 | II |
| TFR241-212112 | 113083 | R 2 1/2 | Rp 1 1/2 | 40,0 | - | 21,0 | II |
| TFR 241-21220 | 113084 | R 2 1/2 | Rp 2 | 40,0 | - | 16,0 | II |
| TFR 241-30112 | 113085 | R 3 | Rp 1 1/2 | 44,0 | 59,0 | 40,0 | III |
| TFR 241-3020 | 113086 | R 3 | Rp 2 | 44,0 | - | 20,0 | II |
| TFR 241-30212 | 113087 | R 3 | Rp 2 1/2 | 44,0 | - | 17,0 | II |

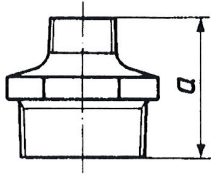

TFD 245-1238

Doppelnippel 245, reduzierend, AG/AG

| Typen Nr. | Artikel Nr. | Gewinde 1 außen | Gewinde 2 außen | a mm |
|---------------|-------------|--------------------|--------------------|---------|
| TFD 245-3814 | 113088 | R 3/8 | R 1/4 | 38,0 |
| TFD 245-1214 | 113089 | R 1/2 | R 1/4 | 44,0 |
| TFD 245-1238 | 113090 | R 1/2 | R 3/8 | 44,0 |
| TFD 245-3438 | 113091 | R 3/4 | R 3/8 | 47,0 |
| TFD 245-3412 | 113092 | R 3/4 | R 1/2 | 47,0 |
| TFD 245-1012 | 113093 | R 1 | R 1/2 | 53,0 |
| TFD 245-1034 | 113094 | R 1 | R 3/4 | 53,0 |
| TFD 245-11434 | 113095 | R 1 1/4 | R 3/4 | 57,0 |
| TFD 245-11410 | 113096 | R 1 1/4 | R 1 | 57,0 |
| TFD 245-11212 | 133569 | R 1 1/2 | R 1/2 | - |
| TFD 245-11234 | 133570 | R 1 1/2 | R 3/4 | 59,0 |
| TFD 245-11210 | 113097 | R 1 1/2 | R 1 | 59,0 |
| TFD245-112114 | 113098 | R 1 1/2 | R 1 1/4 | 59,0 |
| TFD 245-234 | 133571 | R 2 | R 3/4 | - |
| TFD 245-20114 | 113099 | R 2 | R 1 1/4 | 68,0 |
| TFD 245-20112 | 113100 | R 2 | R 1 1/2 | 68,0 |
| TFD245-212112 | 113101 | R 2 1/2 | R 1 1/2 | 75,0 |
| TFD 245-21220 | 113102 | R 2 1/2 | R 2 | 75,0 |
| TFD 245-3020 | 113103 | R 3 | R 2 | 83,0 |
| TFD 245-30212 | 113104 | R 3 | R 2 1/2 | 83,0 |

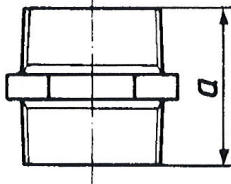

TFD 280-12

Doppelnippel 280, AG/AG

| Typen Nr. | Artikel Nr. | Gewinde außen | a mm |
|-------------|-------------|---------------|------|
| TFD 280-14 | 113105 | R 1/4 | 36,0 |
| TFD 280-38 | 113106 | R 3/8 | 38,0 |
| TFD 280-12 | 113107 | R 1/2 | 44,0 |
| TFD 280-34 | 113108 | R 3/4 | 47,0 |
| TFD 280-10 | 113109 | R 1 | 53,0 |
| TFD 280-114 | 113110 | R 1 1/4 | 57,0 |
| TFD 280-112 | 113111 | R 1 1/2 | 59,0 |
| TFD 280-20 | 113112 | R 2 | 68,0 |
| TFD 280-212 | 113113 | R 2 1/2 | - |
| TFD 280-30 | 113114 | R 3 | - |

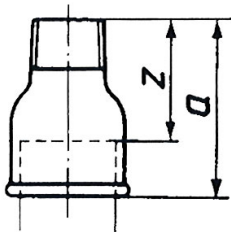

TFM 246-1012

Reduziermuffe 246, IG/AG

| Typen Nr. | Artikel Nr. | Gewinde 1 innen | Gewinde 2 außen | a mm | z mm |
|---------------|-------------|-----------------|-----------------|------|------|
| TFM 246-3814 | 113115 | Rp 3/8 | R 1/4 | 35,0 | 25,0 |
| TFM 246-1214 | 113116 | Rp 1/2 | R 1/4 | 43,0 | 30,0 |
| TFM 246-1238 | 113117 | Rp 1/2 | R 3/8 | 43,0 | 30,0 |
| TFM 246-3412 | 113118 | Rp 3/4 | R 1/2 | 48,0 | 33,0 |
| TFM 246-1012 | 113119 | Rp 1 | R 1/2 | 55,0 | 38,0 |
| TFM 246-1034 | 113120 | Rp 1 | R 3/4 | 55,0 | 38,0 |
| TFM 246-11434 | 113121 | Rp 1 1/4 | R 3/4 | 60,0 | 41,0 |
| TFM 246-11410 | 113122 | Rp 1 1/4 | R 1 | 60,0 | 41,0 |
| TFM 246-11210 | 113123 | Rp 1 1/2 | R 1 | 63,0 | 44,0 |
| TFM246-112114 | 113124 | Rp 1 1/2 | R 1 1/4 | 63,0 | 44,0 |
| TFM 246-2010 | 113125 | Rp 2 | R 1 | 65,0 | 43,0 |
| TFM 246-20114 | 113126 | Rp 2 | R 1 1/4 | 70,0 | 46,0 |
| TFM 246-20112 | 113127 | Rp 2 | R 1 1/2 | 70,0 | 46,0 |
| TFM 246-21220 | 113128 | Rp 2 1/2 | R 2 | - | - |
| TFM 246-3020 | 113129 | Rp 3 | R 2 | - | - |
| TFM 246-30212 | 113130 | Rp 3 | R 2 1/2 | - | - |

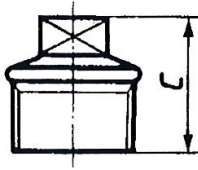

TFS 290-10

Stopfen 290, AG

| Typen Nr. | Artikel Nr. | Gewinde außen | c min. mm |
|-------------|-------------|---------------|-----------|
| TFS 290-14 | 113131 | R 1/4 | 22,0 |
| TFS 290-38 | 113132 | R 3/8 | 24,0 |
| TFS 290-12 | 113133 | R 1/2 | 26,0 |
| TFS 290-34 | 113134 | R 3/4 | 32,0 |
| TFS 290-10 | 113135 | R 1 | 36,0 |
| TFS 290-114 | 113136 | R 1 1/4 | 39,0 |
| TFS 290-112 | 113137 | R 1 1/2 | 41,0 |
| TFS 290-20 | 113138 | R 2 | 48,0 |
| TFS 290-212 | 113139 | R 2 1/2 | 54,0 |
| TFS 290-30 | 113140 | R 3 | 60,0 |



TFK 300-12

Kappe 300, IG

| Typen Nr. | Artikel Nr. | Gewinde innen | a min. mm |
|-------------|-------------|---------------|-----------|
| TFK 300-14 | 113141 | Rp 1/4 | 15,0 |
| TFK 300-38 | 113142 | Rp 3/8 | 17,0 |
| TFK 300-12 | 113143 | Rp 1/2 | 19,0 |
| TFK 300-34 | 113144 | Rp 3/4 | 22,0 |
| TFK 300-10 | 113145 | Rp 1 | 24,0 |
| TFK 300-114 | 113146 | Rp 1 1/4 | 27,0 |
| TFK 300-112 | 113147 | Rp 1 1/2 | 27,0 |
| TFK 300-20 | 113148 | Rp 2 | 32,0 |
| TFK 300-212 | 113149 | Rp 2 1/2 | 35,0 |
| TFK 300-30 | 113150 | Rp 3 | 38,0 |

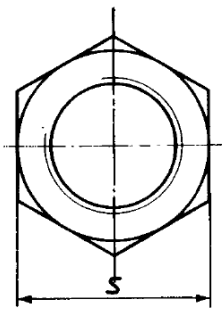

TFG 310-10

Gegenmutter 310, IG

| Typen Nr. | Artikel Nr. | Gewinde außen | a min. mm |
|-------------|-------------|---------------|-----------|
| TFG 310-14 | 113151 | Rp 1/4 | 6,0 |
| TFG 310-38 | 113152 | Rp 3/8 | 7,0 |
| TFG 310-12 | 113153 | Rp 1/2 | 8,0 |
| TFG 310-34 | 113154 | Rp 3/4 | 9,0 |
| TFG 310-10 | 113155 | Rp 1 | 10,0 |
| TFG 310-112 | 113156 | Rp 1 1/2 | 12,0 |
| TFG 310-20 | 113157 | Rp 2 | 13,0 |
| TFG 310-212 | 113158 | Rp 2 1/2 | 16,0 |
| TFG 310-30 | 113159 | Rp 3 | 19,0 |

*Das Maß s für die Schlüsselweiten hängt von der Konstruktion des Fittings ab und bleibt dem Hersteller überlassen.

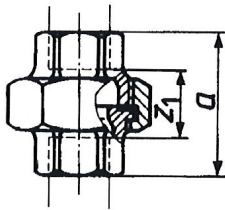

TFV 330-12

Verschraubung 330, flach dichtend, IG/IG, mit NBR-Dichtung (NBR mit Aramidfasern)
Temperatur-Bereich von -20 °C bis 200 °C

| Typen Nr. | Artikel Nr. | Gewinde innen | a mm | z1 mm |
|---------------|-------------|---------------|------|-------|
| TFV 330-14-D | 113160 | Rp/Rp 1/4 | 42,0 | 22,0 |
| TFV 330-38-D | 113161 | Rp/Rp 3/8 | 45,0 | 25,0 |
| TFV 330-12-D | 113162 | Rp/Rp 1/2 | 48,0 | 22,0 |
| TFV 330-34-D | 113163 | Rp/Rp 3/4 | 52,0 | 22,0 |
| TFV 330-10-D | 113164 | Rp/Rp 1 | 58,0 | 24,0 |
| TFV 330-114-D | 113165 | Rp/Rp 1 1/4 | 65,0 | 27,0 |
| TFV 330-112-D | 113166 | Rp/Rp 1 1/2 | 70,0 | 32,0 |
| TFV 330-20-D | 113167 | Rp/Rp 2 | 78,0 | 30,0 |
| TFV 330-212-D | 113168 | Rp/Rp 2 1/2 | 85,0 | 31,0 |
| TFV 330-30-D | 113169 | Rp/Rp 3 | 95,0 | 35,0 |

→ Maximale Temperatur und maximaler Betriebsdruck dürfen nicht gleichzeitig auftreten!

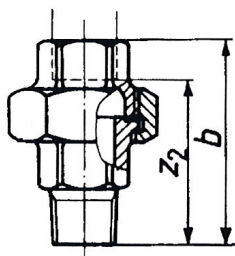

TFV 331-12

Verschraubung 331, flach dichtend, IG/AG, mit NBR-Dichtung (NBR mit Aramidfasern)
Temperatur-Bereich von -20 °C bis 200 °C

| Typen Nr. | Artikel Nr. | Gewinde innen | Gewinde außen | b mm | Z ₂ mm |
|---------------|-------------|---------------|---------------|-------|-------------------|
| TFV 331-14-D | 113170 | Rp 1/4 | R 1/4 | 55,0 | 45,0 |
| TFV 331-38-D | 113171 | Rp 3/8 | R 3/8 | 58,0 | 48,0 |
| TFV 331-12-D | 113172 | Rp 1/2 | R 1/2 | 66,0 | 53,0 |
| TFV 331-34-D | 113173 | Rp 3/4 | R 3/4 | 72,0 | 57,0 |
| TFV 331-10-D | 113174 | Rp 1 | R 1 | 80,0 | 63,0 |
| TFV 331-114-D | 113175 | Rp 1 1/4 | R 1 1/4 | 90,0 | 71,0 |
| TFV 331-112-D | 113176 | Rp 1 1/2 | R 1 1/2 | 95,0 | 76,0 |
| TFV 331-20-D | 113177 | Rp 2 | R 2 | 106,0 | 82,0 |
| TFV 331-212-D | 113178 | Rp 2 1/2 | R 2 1/2 | 118,0 | 91,0 |

→ Maximale Temperatur und maximaler Betriebsdruck dürfen nicht gleichzeitig auftreten!

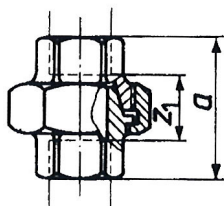

TFV 340-12

Verschraubung 340, konisch dichtend, IG/IG

| Typen Nr. | Artikel Nr. | Gewinde innen | a mm | z1 mm |
|-------------|-------------|---------------|------|-------|
| TFV 340-14 | 113179 | Rp/Rp 1/4 | 42,0 | 22,0 |
| TFV 340-38 | 113180 | Rp/Rp 3/8 | 45,0 | 25,0 |
| TFV 340-12 | 113181 | Rp/Rp 1/2 | 48,0 | 22,0 |
| TFV 340-34 | 113182 | Rp/Rp 3/4 | 52,0 | 22,0 |
| TFV 340-10 | 113183 | Rp/Rp 1 | 58,0 | 24,0 |
| TFV 340-114 | 113184 | Rp/Rp 1 1/4 | 65,0 | 27,0 |
| TFV 340-112 | 113185 | Rp/Rp 1 1/2 | 70,0 | 32,0 |
| TFV 340-20 | 113186 | Rp/Rp 2 | 78,0 | 30,0 |
| TFV 340-212 | 113187 | Rp/Rp 2 1/2 | 85,0 | 31,0 |
| TFV 340-30 | 113188 | Rp/Rp 3 | 95,0 | 35,0 |

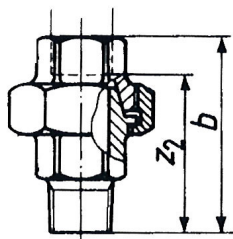

TFV 341-10

Verschraubung 341, konisch dichtend, IG/AG

| Typen Nr. | Artikel Nr. | Gewinde innen | Gewinde außen | b mm | z2 mm |
|-------------|-------------|---------------|---------------|-------|-------|
| TFV 341-14 | 113189 | Rp 1/4 | R 1/4 | 55,0 | 45,0 |
| TFV 341-38 | 113190 | Rp 3/8 | R 3/8 | 58,0 | 48,0 |
| TFV 341-12 | 113191 | Rp 1/2 | R 1/2 | 66,0 | 53,0 |
| TFV 341-34 | 113192 | Rp 3/4 | R 3/4 | 72,0 | 57,0 |
| TFV 341-10 | 113193 | Rp 1 | R 1 | 80,0 | 63,0 |
| TFV 341-114 | 113194 | Rp 1 1/4 | R 1 1/4 | 90,0 | 71,0 |
| TFV 341-112 | 113195 | Rp 1 1/2 | R 1 1/2 | 95,0 | 76,0 |
| TFV 341-20 | 113196 | Rp 2 | R 2 | 106,0 | 82,0 |
| TFV 341-212 | 113197 | Rp 2 1/2 | Rp 2 1/2 | 118,0 | 91,0 |
| TFV 341-30 | 113198 | Rp 3 | Rp 3 | 130,0 | 100,0 |

Flachdichtung für Tempergussfittings (NBR mit Aramidfasern)

Temperatur-Bereich von -20 °C bis 200 °C

| Typen Nr. | Artikel Nr. | für Anschlussgröße (Zoll) | Außen-Ø mm | Innen-Ø mm | Stärke mm |
|-----------|-------------|------------------------------|---------------|---------------|--------------|
| TFD 14 | 113199 | 1/4 | 24,0 | 17,0 | 2,0 |
| TFD 38 | 113200 | 3/8 | 27,0 | 19,0 | 2,0 |
| TFD 12 | 113201 | 1/2 | 30,0 | 21,0 | 2,0 |
| TFD 34 | 113202 | 3/4 | 38,0 | 27,0 | 2,0 |
| TFD 10 | 113203 | 1 | 44,0 | 32,0 | 2,0 |
| TFD 114 | 113204 | 1 1/4 | 55,0 | 42,0 | 2,0 |
| TFD 112 | 113205 | 1 1/2 | 62,0 | 46,0 | 2,0 |
| TFD 20 | 113206 | 2 | 78,0 | 60,0 | 2,0 |
| TFD 212 | 113207 | 2 1/2 | 97,0 | 75,0 | 2,0 |
| TFD 30 | 113208 | 3 | 110,0 | 88,0 | 2,0 |

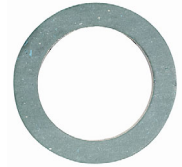

TFD 12

→ Maximale Temperatur und maximaler Betriebsdruck dürfen nicht gleichzeitig auftreten!

Bei den angegebenen Abmessungen handelt es sich um Circa-Maße in mm.

Die Maße der Schlüsselweiten bleiben laut Vorgabe DIN EN 10242 dem Hersteller überlassen und können daher variieren.