



tst Accessories Installation and Maintenance



Connection

Part No.

Automatic Hose Reel without hose, including swivel mounting bracket

G3/8"	606 00 101
G1/2"	606 00 102

Type: Stainless steel

Materials
 Drum No. 1.4301 / UNS S30400
 Mechanism No. 2.0401
 Seal FPM

G1/2"	606 00 105
-------	------------

Type: Stainless steel, aseptic, polished

Materials
 Drum No. 1.4301 / UNS S30400
 Mechanism No. 1.4301 / UNS S30400
 Seal FPM



G3/8"	606 00 104
G1/2"	606 00 103

Type: Stainless Steel, painted

Materials
 Drum No. 1.0737 / painted
 Mechanism No. 2.0401
 Seal FPM

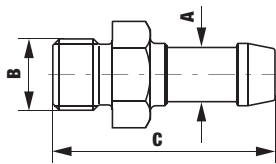

A	B	C	Part No.
LW6	G1/8	38.0	353 00 065
LW8	G1/8	38.0	353 00 066
LW6	G1/4	41.0	353 00 070
LW8	G1/4	41.0	353 00 071
LW10	G1/4	41.0	353 00 072
LW8	G3/8	43.0	353 00 075
LW10	G3/8	43.0	353 00 076
LW13	G3/8	43.0	353 00 077

Connecting Plug for Hoses

Material Stainless Steel
 No. 1.44351 UNS S31603

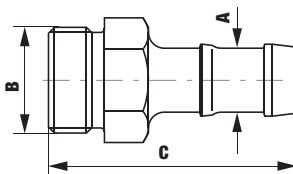

A	B	C	Part No.
LW13	G1/2	59.0	353 00 082
LW16	G1/2	59.0	353 00 083
LW19	G1/2	59.0	353 00 084
LW16	G3/4	62.0	353 00 086
LW19	G3/4	62.0	353 00 087
LW25	G3/4	71.0	353 00 088
LW19	G1	69.0	353 00 089
LW25	G1	75.0	353 00 090
LW32	G1	80.0	353 00 091

Connecting Plug for Hoses with 2 Connectors

Material Stainless Steel
 No. 1.4435 / UNS S31603

A variety of additional stainless steel adaptors available upon request, e.g.
 - reducers male-female threads
 - connecting plugs for hoses